



CREATING A BETTER
EXPERIENCE

PHDX™



High Density
PLASMA

TORCHES & CONSUMABLES

AMERICAN TORCH TIP®
6212 29th Street East, Bradenton, FL
P: 941-753-7557
E: Sales@attcusa.com
AmericanTorchTip.com



50 - 400 AMP TORCH KITS

Part #	Amp	Power Supply	Plasma Gas	Shield Gas	Material	Notes
90-7950	400	400X	O ₂	Air	Mild Steel	Straight & Bevel Cutting
90-7951	260	260X	O ₂	Air	Mild Steel	Standard Cutting
90-7952	200	260X	O ₂	Air	Mild Steel	Standard Cutting
90-7953	130	260X	O ₂	Air	Mild Steel	Standard Cutting
90-7954	80	260X	O ₂	Air	Mild Steel	Standard Cutting
90-7905	50	260X	O ₂	Air	Mild Steel	Standard Cutting
90-7907	260	260X	O ₂	Air	Mild Steel	Bevel Cutting
90-7910	130	260X	O ₂	Air	Mild Steel	Bevel Cutting

PLASMA HIGH DENSITY

LOWER OPERATING COSTS

- Bevel less than 2°
- Minimal dross

LIFETIME WARRANTY

- The best torch warranty in the industry

MADE IN THE USA

- Engineered to stringent tolerances

QUALITY CHECKED

- All consumables are tested for dimensional accuracy



Qty	Parts
1	Torch Body
10	Electrodes
10	Nozzles
2	Swirl Rings
1	Nozzle Retaining Cap
2	Shields
1	Shield Cap
1	Consumables Removal Tool
1	Water Tube Removal Tool
1	1/4 oz. Silicon Lubricant
1	O-ring Kit

CLEANCUT™ TECHNOLOGY

Upgrade Your Consumables

CleanCut™'s patented nozzle and electrode allow your consumables to run longer and cut cleaner making for less downtime and post grind clean-up.

Learn more at:
AmericanTorchTip.com/cleancut



30 - 400 AMP CONSUMABLES

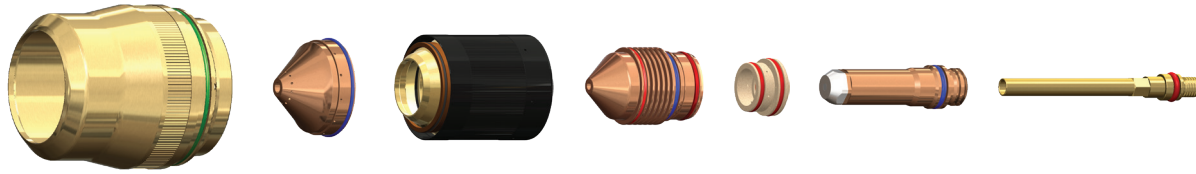

260 amp Mild Steel consumables illustrated above

Mild Steel							
Amp	Shield Cap	Shield	Nozzle Retaining Cap	Nozzle	Swirl Ring	Electrode	Water Tube
30 A	90-0747	60-0194	90-0754	60-0193	90-0180	60-0192	90-0340
50 A	90-0747	90-0555	90-0754	90-0554	90-0553	90-0552	90-0340
80 A	97-0200	97-0246	97-1365	97-0243	90-0179	97-0240	90-0700
130 A	97-0200	97-0255	97-1365	97-0252	90-0179	97-0249 (CleanCut™)	90-0700
200 A	97-0200	97-0513	97-1365	97-0261	90-0405	97-0258 (CleanCut™)	90-0700
260 A	97-0200	97-0491	97-0365	97-0279	90-0436	97-0276 (CleanCut™)	90-0571
400 A	97-0200	97-4002	97-0365	90-0632	*220631	90-0530 (CleanCut™)	90-0571
80 A bevel	90-0637	90-0742	*220845	90-0806	90-0179	90-0802	90-0700
130 A bevel	97-0200	97-0255	97-1365	97-0252	90-0179	97-0249 (CleanCut™)	90-0700
200 A bevel	97-0200	97-0513	97-1365	97-0261	90-0405	97-0258 (CleanCut™)	90-0700
260 A bevel	97-0200	97-0491	97-0365	97-0279	90-0436	97-0276 (CleanCut™)	90-0571
400 A bevel	97-0200	97-4002	97-0365	90-0632	*220631	90-0530 (CleanCut™)	90-0571

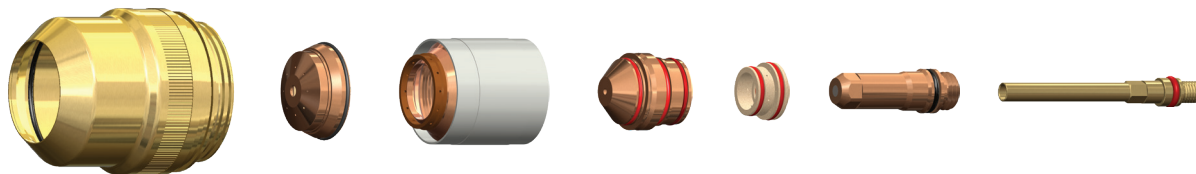

260 amp Stainless Steel consumables illustrated above

Stainless Steel							
Amp	Shield Cap	Shield	Nozzle Retaining Cap	Nozzle	Swirl Ring	Electrode	Water Tube
45 A	90-0747	90-0202	90-0755	90-0201	90-0180	90-0308	90-0340
80 A	90-0747	90-0338	90-0755	90-0337	90-0179	90-0339	90-0340
130 A	90-0747	90-0198	90-0755 (H35) 90-0756 (N ₂)	90-0197	90-0179	90-0307	90-0340
200 A	90-0637	90-0762	*220758	90-0343	90-0342	90-0307	90-0340
260 A	90-0637	90-0763	*220758	90-0406	90-0405	90-0307	90-0340
400 A	90-0637	90-0707	*220712	90-0708	90-0405	90-0709	90-0571
130 A bevel	90-0637	90-0738	*220739	90-0656	90-0179	90-0606	90-0571
260 A bevel	90-0637	90-0738	*220739	*220607	90-0405	90-0606	90-0571
400 A bevel	90-0637	90-0707	*220712	90-0708	90-0405	90-0709	90-0571

45 - 400 AMP CONSUMABLES

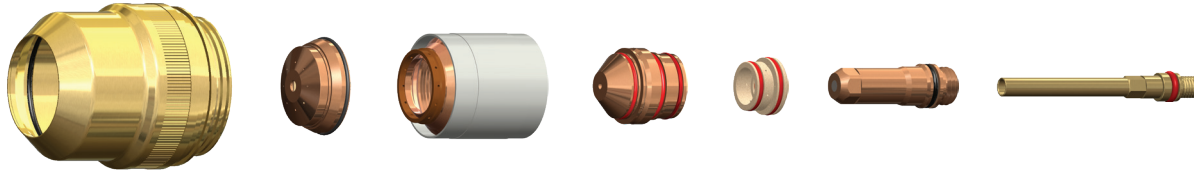

260 amp Aluminum consumables illustrated above

Aluminum							
Amp	Shield Cap	Shield	Nozzle Retaining Cap	Nozzle	Swirl Ring	Electrode	Water Tube
45 A	90-0747	90-0202	90-0756	90-0201	90-0180	90-0308	90-0340
130 A	90-0747	90-0198	90-0755 (H35) 90-0756 (Air)	90-0197	90-0179	90-0307 (H35) / 90-0181 (Air)	90-0340
200 A	90-0637	90-0762	*220759	90-0346	90-0342	90-0307	90-0340
260 A	90-0637	90-0763	*220758	90-0406	90-0405	90-0307	90-0340
400 A	90-0637	90-0707	*220712	90-0708	90-0405	90-0709	90-0571

PHDX™ PARTS & ACCESSORIES

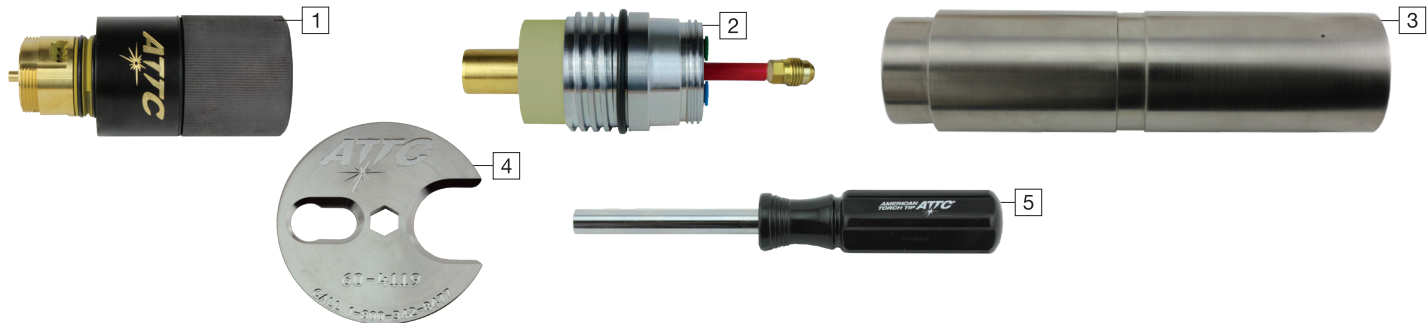

Pos	Part #	Desc
1	90-0706	Torch body
2	*220705	Quick disconnect receptacle
3	90-0788	Torch mounting sleeve assembly Short 4.5"
	90-0789	Torch mounting sleeve assembly Standard 7"
	90-0790	Torch mounting sleeve assembly Long 9"
4	60-4119	Consumable tool
5	60-0000	Water tube tool
	90-8879	Torch kit: O-rings, Water tube, Seal
	90-8880	Quick disconnect kit: O-ring, Connector

† American Torch Tip Company (ATTC) is a proud US manufacturer of more than 80 years producing products for 6 major cutting and welding technologies. ATTC is in no way affiliated with the above-named original equipment manufacturer(s). References to the above-named manufacturers, tradenames and part numbers are for your convenience only. Most parts advertised for sale are made by or for American Torch Tip and other parts as indicated are original parts manufactured by above-named, original equipment manufacturer (OEM) and are simply being re-sold by American Torch Tip. Footnotes: * = OEM; # = American Torch Tip is licensed to make and sell this part by named manufacturer; ATTC and ATT suffix = This part is an original American Torch Tip design and is not manufactured identical to the OEM design; ® indicates a registered trademark, trade name, or product name of the above-named company. PHD™, PHDX™, Lightning®, Waltec™, Integra™, Lasertec® Laser Division of American Torch Tip®, Multi-Use™ and ProMix™ are trademarks owned by American Torch Tip Company. © Copyright 2023, American Torch Tip Company